

### 产品结构

介质：金属化聚丙烯薄膜  
 外壳：塑料外壳封装，  
 内部灌封：树脂填充（UL94 V-0）

### 电气特性

工作温度：-40 至 +105 °C  
 容量范围：0.10 至 40μF  
 额定电压：330 至 850 VDC  
 容量偏差：±5% , ±10%  
 损耗因素： $\leq 10 \times 10^{-4}$  @ 1KHz, 20±5°C  
 预期寿命：100,000 小时 @  $U_n$ , 70 °C(热点温度)  
 极间耐压：1.5 $U_n$  (DC) @ 10s, 20±5°C  
 极壳耐压：(1.5 $U_n$ +1000)VAC, 最小 3000VAC (10s,50Hz)  
 (IR×Cn) 30000s (不超过 30GΩ),  
 绝缘电阻：100VDC (20±5°C), 1 分钟

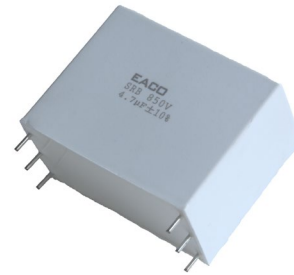

### 应用

AC 应用

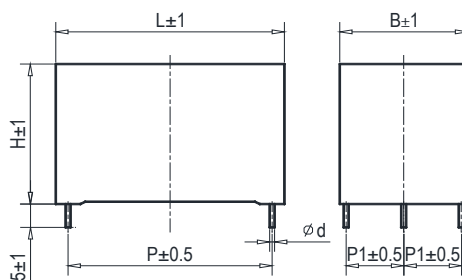
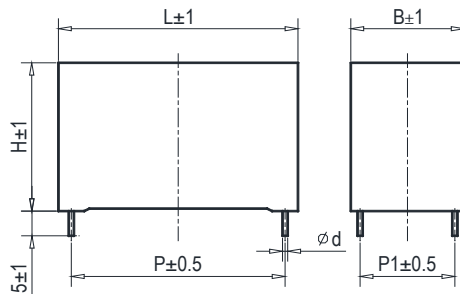
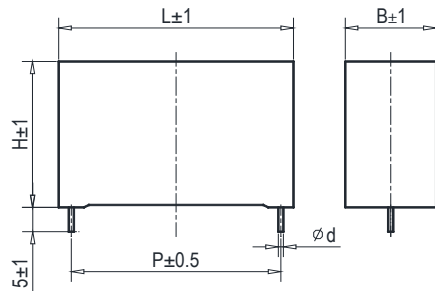

## 特性参数

订货代码	容量 ( $\mu\text{F}$ )	尺寸 (mm)						Du/dt (v/ $\mu\text{s}$ )	I <sub>peak</sub> (A)	I <sub>Max</sub> @60°C @10KHz(A)	ESR@10KHz (m $\Omega$ )
		L	B	H	P	P1	d				
<b>Un 330VDC , Urms 200VAC , Us 495V</b>											
SRB-330-0.68-2T	0.68	26.5	8.5	17.0	22.5		0.8	60	41	4	33.8
SRB-330-1.0-2T	1.0	26.5	10.0	18.5	22.5		0.8	60	60	5	25.0
SRB-330-1.5-2T	1.5	26.5	12.0	22.0	22.5		0.8	60	90	5	18.4
SRB-330-1.5-2V	1.5	31.0	11.0	20.0	27.5		0.8	45	68	5	24.0
SRB-330-2.0-2V	2.0	31.0	13.0	22.0	27.5		1.0	45	90	7	18.0
SRB-330-2.2-2V	2.2	31.0	13.0	22.0	27.5		1.0	45	99	7	16.7
SRB-330-2.5-2V	2.5	31.0	13.0	22.0	27.5		1.0	45	113	8	15.1
SRB-330-3.0-2V	3.0	31.0	15.0	24.5	27.5		1.0	45	135	8	13.1
SRB-330-3.3-2V	3.3	31.0	15.0	24.5	27.5		1.0	45	149	8	12.2
SRB-330-4.7-2V	4.7	31.0	18.0	33.0	27.5		1.2	45	212	11	8.6
SRB-330-4.7-4V	4.7	31.0	18.0	33.0	27.5	5.1	1.2	45	212	13	7.8
SRB-330-5.0-2V	5.0	31.0	18.0	33.0	27.5		1.2	45	225	11	8.2
SRB-330-5.0-4V	5.0	31.0	18.0	33.0	27.5	5.1	1.2	45	225	13	7.4
SRB-330-6.8-2V	6.8	31.0	22.0	31.0	27.5		1.2	45	306	11	6.6
SRB-330-6.8-4V	6.8	31.0	22.0	31.0	27.5	10.2	1.2	45	306	15	5.7
SRB-330-6.8-2F	6.8	42.5	17.0	28.0	37.5		1.2	30	204	11	10.2
SRB-330-15-2F	15	42.5	28.0	37.0	37.5		1.2	30	450	11	5.6
SRB-330-15-4F	15	42.5	28.0	37.0	37.5	10.2	1.2	30	450	21	4.8
SRB-330-20-2F	20	42.5	30.0	45.0	37.5		1.2	30	600	11	4.7
SRB-330-20-4F	20	42.5	30.0	45.0	37.5	20.3	1.2	30	600	23	3.8
SRB-330-25-2G	25	57.5	30.0	45.0	52.5		1.2	17	425	11	6.2
SRB-330-25-4G	25	57.5	30.0	45.0	52.5	20.3	1.2	17	425	23	5.4
SRB-330-30-2G	30	57.5	30.0	45.0	52.5		1.2	17	510	11	5.5
SRB-330-30-4G	30	57.5	30.0	45.0	52.5	20.3	1.2	17	510	23	4.6
SRB-330-30-6G	30	57.5	30.0	45.0	52.5	10.2	1.2	17	510	26	4.3
SRB-330-33-2G	33	57.5	35.0	50.0	52.5		1.2	17	561	11	5.1
SRB-330-33-4G	33	57.5	35.0	50.0	52.5	20.3	1.2	17	561	23	4.3
SRB-330-33-6G	33	57.5	35.0	50.0	52.5	10.2	1.2	17	561	29	4.0
SRB-330-35-2G	35	57.5	35.0	50.0	52.5		1.2	17	595	11	4.9
SRB-330-35-4G	35	57.5	35.0	50.0	52.5	20.3	1.2	17	595	23	4.1
SRB-330-35-6G	35	57.5	35.0	50.0	52.5	10.2	1.2	17	595	30	3.8
SRB-330-40-2G	40	57.5	35.0	50.0	52.5		1.2	17	680	11	4.5
SRB-330-40-4G	40	57.5	35.0	50.0	52.5	20.3	1.2	17	680	23	3.7
SRB-330-40-6G	40	57.5	35.0	50.0	52.5	10.2	1.2	17	680	32	3.4
<b>Un 400VDC , Urms 250VAC , Us 600V</b>											
SRB-400-0.47-2T	0.47	26.5	8.5	17.0	22.5		0.8	75	35	4	41.3
SRB-400-0.68-2T	0.68	26.5	10.0	18.5	22.5		0.8	75	51	5	30.7
SRB-400-0.68-2V	0.68	31.0	9.0	18.0	27.5		0.8	55	37	4	40.2
SRB-400-1.0-2T	1.0	26.5	12.0	22.0	22.5		0.8	75	75	5	22.7
SRB-400-1.0-2V	1.0	31.0	11.0	20.0	27.5		0.8	55	55	5	29.6
SRB-400-1.5-2V	1.5	31.0	13.0	22.0	27.5		1.0	55	83	7	20.2
SRB-400-2.0-2V	2.0	31.0	15.0	24.5	27.5		1.0	55	110	8	16.0
SRB-400-2.2-2V	2.2	31.0	15.0	24.5	27.5		1.0	55	121	8	14.9
SRB-400-2.5-2V	2.5	31.0	17.0	28.0	27.5		1.0	55	138	8	13.4
SRB-400-3.0-2V	3.0	31.0	17.0	28.0	27.5		1.2	55	165	10	10.9
SRB-400-3.0-4V	3.0	31.0	17.0	28.0	27.5	5.1	1.2	55	165	11	10.1
SRB-400-3.3-2V	3.3	31.0	18.0	33.0	27.5		1.2	55	182	11	10.1
SRB-400-3.3-4V	3.3	31.0	18.0	33.0	27.5	5.1	1.2	55	182	12	9.3
SRB-400-4.0-2V	4.0	31.0	18.0	33.0	27.5		1.2	55	220	11	8.7
SRB-400-4.0-4V	4.0	31.0	18.0	33.0	27.5	10.2	1.2	55	220	13	7.9

## 特性参数

订货代码	容量 ( $\mu\text{F}$ )	尺寸 (mm)						Du/dt ( $\text{V}/\mu\text{s}$ )	I <sub>peak</sub> (A)	I <sub>max</sub> @60°C @10KHz(A)	ESR@10KHz ( $\text{m}\Omega$ )
		L	B	H	P	P1	d				
<b>Un 400VDC , Urms 250VAC , Us 600V</b>											
SRB-400-4.7-2V	4.7	31.0	22.0	31.0	27.5		1.2	55	259	11	7.7
SRB-400-4.7-4V	4.7	31.0	22.0	31.0	27.5	10.2	1.2	55	259	14	6.9
SRB-400-4.7-2F	4.7	42.5	17.0	28.0	37.5		1.2	40	188	10	13.7
SRB-400-5.0-2F	5.0	42.5	18.0	31.5	37.5		1.2	40	200	11	11.4
SRB-400-6.8-2F	6.8	42.5	22.0	30.0	37.5		1.2	40	272	11	10.2
SRB-400-6.8-4F	6.8	42.5	22.0	30.0	37.5	10.2	1.2	40	272	14	9.3
SRB-400-10-2F	10	42.5	28.0	37.0	37.5		1.2	40	400	11	6.7
SRB-400-10-4F	10	42.5	28.0	37.0	37.5	20.3	1.2	40	400	19	5.8
SRB-400-10-6F	10	42.5	28.0	37.0	37.5	10.2	1.2	40	400	20	5.6
SRB-400-15-2F	15	42.5	30.0	45.0	37.5		1.2	40	600	11	5.0
SRB-400-15-4F	15	42.5	30.0	45.0	37.5	20.3	1.2	40	600	23	4.2
SRB-400-15-6F	15	42.5	30.0	45.0	37.5	10.2	1.2	40	600	25	3.9
SRB-400-20-2G	20	57.5	30.0	45.0	52.5		1.2	20	400	11	6.4
SRB-400-20-4G	20	57.5	30.0	45.0	52.5	20.3	1.2	20	400	23	5.6
SRB-400-20-6G	20	57.5	30.0	45.0	52.5	10.2	1.2	20	400	24	5.3
SRB-400-22-2G	22	57.5	35.0	50.0	52.5		1.2	20	440	11	6.0
SRB-400-22-4G	22	57.5	35.0	50.0	52.5	20.3	1.2	20	440	23	5.2
SRB-400-22-6G	22	57.5	35.0	50.0	52.5	10.2	1.2	20	440	27	4.9
SRB-400-25-2G	25	57.5	35.0	50.0	52.5		1.2	20	500	11	5.5
SRB-400-25-4G	25	57.5	35.0	50.0	52.5	20.3	1.2	20	500	23	4.6
SRB-400-25-6G	25	57.5	35.0	50.0	52.5	10.2	1.2	20	500	28	4.4
<b>Un 600VDC , Urms 330VAC , Us 900V</b>											
SRB-600-0.22-2T	0.22	26.5	8.5	17.0	22.5		0.8	95	21	3	67.3
SRB-600-0.33-2T	0.33	26.5	10.0	18.5	22.5		0.8	95	31	4	48.0
SRB-600-0.47-2T	0.47	26.5	11.0	20.0	22.5		0.8	95	45	4	36.4
SRB-600-0.68-2V	0.68	31.0	11.0	20.0	27.5		0.8	75	51	5	34.9
SRB-600-1.0-2V	1.0	31.0	15.0	24.5	27.5		1.0	75	75	6	24.2
SRB-600-1.5-2V	1.5	31.0	18.0	33.0	27.5		1.2	75	113	9	16.5
SRB-600-2.0-2V	2.0	31.0	18.0	33.0	27.5		1.2	75	150	10	13.0
SRB-600-2.0-4V	2.0	31.0	18.0	33.0	27.5	10.2	1.2	75	150	10	12.1
SRB-600-2.2-2V	2.2	31.0	18.0	33.0	27.5		1.2	75	165	10	12.0
SRB-600-2.2-4V	2.2	31.0	18.0	33.0	27.5	10.2	1.2	75	165	11	11.2
SRB-600-4.0-2F	4.0	42.5	22.0	30.0	37.5		1.2	55	220	11	11.4
SRB-600-4.0-4F	4.0	42.5	22.0	30.0	37.5	10.2	1.2	55	220	13	10.6
SRB-600-4.7-2F	4.7	42.5	28.0	37.0	37.5		1.2	55	259	11	10.0
SRB-600-4.7-4F	4.7	42.5	28.0	37.0	37.5	10.2	1.2	55	259	15	9.2
SRB-600-5.0-2F	5.0	42.5	28.0	37.0	37.5		1.2	55	275	11	9.6
SRB-600-5.0-4F	5.0	42.5	28.0	37.0	37.5	10.2	1.2	55	275	16	8.7
SRB-600-6.8-2F	6.8	42.5	30.0	45.0	37.5		1.2	55	374	11	7.5
SRB-600-6.8-4F	6.8	42.5	30.0	45.0	37.5	20.3	1.2	55	374	19	6.7
SRB-600-9.0-2F	9.0	42.5	30.0	45.0	37.5		1.2	55	495	11	6.1
SRB-600-9.0-4F	9.0	42.5	30.0	45.0	37.5	20.3	1.2	55	495	21	5.3
SRB-600-9.0-6F	9.0	42.5	30.0	45.0	37.5	10.2	1.2	55	495	22	5.0
SRB-600-10-2G	10	57.5	30.0	45.0	52.5		1.2	30	300	11	8.8
SRB-600-10-4G	10	57.5	30.0	45.0	52.5	20.3	1.2	30	300	20	8.0
SRB-600-15-2G	15	57.5	35.0	50.0	52.5		1.2	30	450	11	6.5
SRB-600-15-4G	15	57.5	35.0	50.0	52.5	20.3	1.2	30	450	23	5.6
SRB-600-15-6G	15	57.5	35.0	50.0	52.5	10.2	1.2	30	450	25	5.4

## 特性参数

订货代码	容量 ( $\mu$ F)	尺寸 (mm)						Du/dt (v/ $\mu$ s)	I <sub>peak</sub> (A)	I <sub>Max</sub> @60°C @10KHz(A)	ESR@10KHz (m $\Omega$ )
		L	B	H	P	P1	d				
<b>Un 700VDC , Urms 400VAC , Us 1050V</b>											
SRB-700-0.15-2T	0.15	26.5	8.5	17.0	22.5		0.8	135	20	3	82.0
SRB-700-0.22-2T	0.22	26.5	10.0	18.5	22.5		0.8	135	30	3	61.0
SRB-700-0.33-2T	0.33	26.5	11.0	20.0	22.5		0.8	135	45	4	43.1
SRB-700-0.33-2V	0.33	31.0	11.0	20.0	27.5		0.8	105	35	4	55.1
SRB-700-0.47-2V	0.47	31.0	13.0	22.0	27.5		1.0	105	49	5	40.0
SRB-700-0.68-2V	0.68	31.0	15.0	24.5	27.5		1.0	105	71	6	28.7
SRB-700-1.0-2V	1.0	31.0	17.0	28.0	27.5		1.2	105	105	8	19.9
SRB-700-1.0-4V	1.0	31.0	18.0	33.0	27.5	10.2	1.2	105	105	8	19.1
SRB-700-1.5-2V	1.5	31.0	22.0	31.0	27.5		1.2	105	158	10	14.0
SRB-700-1.5-4V	1.5	31.0	22.0	31.0	27.5	10.2	1.2	105	158	10	13.4
SRB-700-1.5-2F	1.5	42.5	17.0	28.0	37.5		1.2	70	105	8	21.9
SRB-700-2.0-2F	2.0	42.5	22.0	30.0	37.5		1.2	70	140	10	17.0
SRB-700-2.2-2F	2.2	42.5	22.0	30.0	37.5		1.2	70	154	10	15.9
SRB-700-2.2-4F	2.2	42.5	22.0	30.0	37.5	10.2	1.2	70	154	11	15.1
SRB-700-3.0-2F	3.0	42.5	28.0	37.0	37.5		1.2	70	210	11	12.1
SRB-700-3.0-4F	3.0	42.5	28.0	37.0	37.5	20.3	1.2	70	210	14	11.2
SRB-700-3.3-2F	3.3	42.5	28.0	37.0	37.5		1.2	70	231	11	11.3
SRB-700-3.3-4F	3.3	42.5	28.0	37.0	37.5	20.3	1.2	70	231	14	10.5
SRB-700-4.0-2F	4.0	42.5	28.0	37.0	37.5		1.2	70	280	11	10.4
SRB-700-4.0-4F	4.0	42.5	28.0	37.0	37.5	20.3	1.2	70	280	15	9.4
SRB-700-4.7-2F	4.7	42.5	30.0	45.0	37.5		1.2	70	329	11	8.5
SRB-700-4.7-4F	4.7	42.5	30.0	45.0	37.5	20.3	1.2	70	329	18	7.6
SRB-700-5.0-2F	5.0	42.5	30.0	45.0	37.5		1.2	70	350	11	8.1
SRB-700-5.0-4F	5.0	42.5	30.0	45.0	37.5	20.3	1.2	70	350	18	7.3
SRB-700-6.0-2F	6.0	42.5	33.0	45.0	37.5		1.2	70	420	11	7.5
SRB-700-6.0-4F	6.0	42.5	33.0	45.0	37.5	20.3	1.2	70	420	20	6.7
SRB-700-6.8-2G	6.8	57.5	30.0	45.0	52.5		1.2	40	272	11	10.3
SRB-700-6.8-4G	6.8	57.5	30.0	45.0	52.5	20.3	1.2	40	272	18	9.5
SRB-700-8.0-2G	8.0	57.5	35.0	50.0	52.5		1.2	40	320	11	9.0
SRB-700-8.0-4G	8.0	57.5	35.0	50.0	52.5	20.3	1.2	40	320	21	8.2
SRB-700-8.0-6G	8.0	57.5	35.0	50.0	52.5	10.2	1.2	40	320	21	7.8
SRB-700-9.0-2G	9.0	57.5	35.0	50.0	52.5		1.2	40	360	11	8.2
SRB-700-9.0-4G	9.0	57.5	35.0	50.0	52.5	20.3	1.2	40	360	22	7.3
SRB-700-9.0-6G	9.0	57.5	35.0	50.0	52.5	10.2	1.2	40	360	22	7.0
<b>Un 850VDC , Urms 450VAC , Us 1275V</b>											
SRB-850-0.10-2T	0.10	26.5	8.5	17.0	22.5		0.8	300	30	2	111.6
SRB-850-0.10-2V	0.10	31.0	9.0	18.0	27.5		0.8	200	20	2	138.4
SRB-850-0.15-2T	0.15	26.5	10.0	18.5	22.5		0.8	300	45	3	78.4
SRB-850-0.15-2V	0.15	31.0	9.0	18.0	27.5		0.8	200	30	3	98.4
SRB-850-0.22-2T	0.22	26.5	11.0	20.0	22.5		0.8	300	66	3	56.1
SRB-850-0.22-2V	0.22	31.0	11.0	20.0	27.5		0.8	200	44	3	71.5
SRB-850-0.33-2V	0.33	31.0	13.0	22.0	27.5		1.0	200	66	4	48.6
SRB-850-0.47-2V	0.47	31.0	15.0	24.5	27.5		1.0	200	94	5	36.0
SRB-850-0.68-2V	0.68	31.0	17.0	28.0	27.5		1.2	200	136	7	25.1
SRB-850-0.68-4V	0.68	31.0	17.0	28.0	27.5	5.1	1.2	200	136	7	24.5
SRB-850-1.0-2V	1.0	31.0	18.0	33.0	27.5		1.2	200	200	8	18.3
SRB-850-1.0-4V	1.0	31.0	18.0	33.0	27.5	10.2	1.2	200	200	9	17.5
SRB-850-1.0-2F	1.0	42.5	17.0	28.0	37.5		1.2	110	110	7	27.5
SRB-850-1.5-2F	1.5	42.5	22.0	30.0	37.5		1.2	110	165	9	19.5
SRB-850-2.0-2F	2.0	42.5	28.0	37.0	37.5		1.2	110	220	11	15.2

## 特性参数

订货代码	容量 ( $\mu\text{F}$ )	尺寸 (mm)						Du/dt ( $\text{V}/\mu\text{s}$ )	I <sub>peak</sub> (A)	I <sub>Max</sub> @60°C @10KHz(A)	ESR@10KHz ( $\text{m}\Omega$ )
		L	B	H	P	P1	d				
Un 850VDC , Urms 450VAC , Us 1275V											
SRB-850-2.0-4F	2.0	42.5	28.0	37.0	37.5	10.2	1.2	110	220	12	14.2
SRB-850-2.2-2F	2.2	42.5	28.0	37.0	37.5		1.2	110	242	11	14.0
SRB-850-2.2-4F	2.2	42.5	28.0	37.0	37.5	10.2	1.2	110	242	13	13.2
SRB-850-2.5-2F	2.5	42.5	28.0	37.0	37.5		1.2	110	275	11	12.6
SRB-850-2.5-4F	2.5	42.5	28.0	37.0	37.5	20.3	1.2	110	275	14	11.7
SRB-850-3.0-2F	3.0	42.5	30.0	45.0	37.5		1.2	110	330	11	10.8
SRB-850-3.0-4F	3.0	42.5	30.0	45.0	37.5	20.3	1.2	110	330	16	9.8
SRB-850-3.0-6F	3.0	42.5	30.0	45.0	37.5	10.2	1.2	110	330	16	9.6
SRB-850-3.3-2F	3.3	42.5	30.0	45.0	37.5		1.2	110	363	11	10.0
SRB-850-3.3-4F	3.3	42.5	30.0	45.0	37.5	20.3	1.2	110	363	16	9.2
SRB-850-3.3-6F	3.3	42.5	30.0	45.0	37.5	10.2	1.2	110	363	17	8.9
SRB-850-4.0-2G	4.0	57.5	30.0	45.0	52.5		1.2	55	220	11	13.9
SRB-850-4.0-4G	4.0	57.5	30.0	45.0	52.5	20.3	1.2	55	220	15	12.9
SRB-850-4.0-6G	4.0	57.5	30.0	45.0	52.5	10.2	1.2	55	220	16	12.6
SRB-850-4.7-2G	4.7	57.5	30.0	45.0	52.5		1.2	55	259	11	12.2
SRB-850-4.7-4G	4.7	57.5	30.0	45.0	52.5	20.3	1.2	55	259	16	11.2
SRB-850-4.7-6G	4.7	57.5	30.0	45.0	52.5	10.2	1.2	55	259	17	10.9
SRB-850-5.6-2G	5.6	57.5	35.0	50.0	52.5		1.2	55	308	11	10.5
SRB-850-5.6-4G	5.6	57.5	35.0	50.0	52.5	20.3	1.2	55	308	19	9.7
SRB-850-5.6-6G	5.6	57.5	35.0	50.0	52.5	10.2	1.2	55	308	19	9.3
SRB-850-6.0-2G	6.0	57.5	35.0	50.0	52.5		1.2	55	330	11	9.9
SRB-850-6.0-4G	6.0	57.5	35.0	50.0	52.5	20.3	1.2	55	330	20	9.1
SRB-850-6.0-6G	6.0	57.5	35.0	50.0	52.5	10.2	1.2	55	330	20	8.8