

产品结构

介质：金属化聚丙烯薄膜
 外壳：塑料外壳封装
 内部灌封：树脂填充 (UL94 V-0)

电气特性

工作温度：-40 °C 至 +105 °C
 容量范围：2×0.22 至 2×3.0μF
 额定电压：700 至 1700 VDC
 容量偏差：±5% , ±10%
 损耗因素：≤6×10⁻⁴ @ 1KHz, 20±5°C
 预期寿命：100,000 小时 @ Un, 70 °C (热点温度)
 极间耐压：1.5Un (DC) @ 10s, 20±5°C
 极壳耐压：(1.5Un+1000)VAC, 最小 3000VAC (10s,50Hz)
 绝缘电阻：(IR×Cn) 30000s (不超过 30GΩ),
 100VDC (20±5°C), 1 分钟



应用

三电平 IGBT 模块突波吸收

订货代码说明:

STM -1200 -2×0.47 - U P #

P2 间距

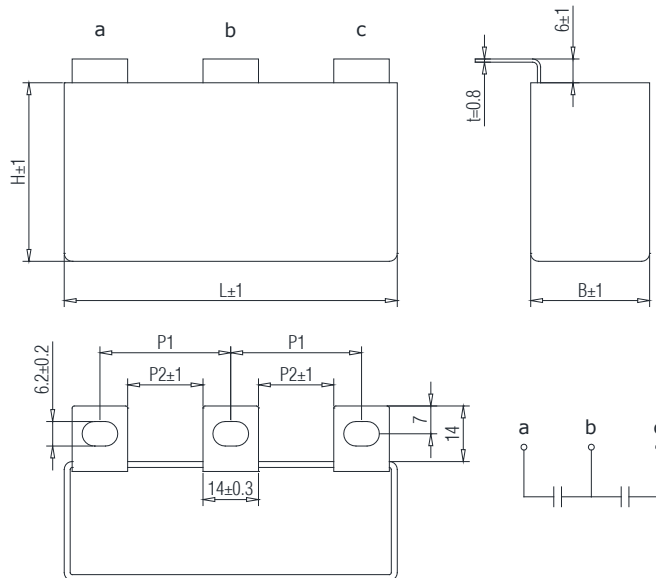

安装孔尺寸和安装片间距(mm)

安装片 U 安装孔径 : M6			
P2	P1	P2	P1
11	24-26	19	32-34

特性参数

订货代码	容量 (μF)	尺寸(mm)			Du/dt (v/ μs)	Ipeak (A)	Ls (nH)	I _{Max} @60°C @100KHz (A)	ESR@100KHz (m Ω)
		L	B	H					
Un 700VDC , Urms 380VAC , Us 1050V									
STM-700-2x1.0-UP#	2x1.0	72.5	30.0	45.0	325	325	≤ 35	2x16.9	2x3.2
STM-700-2x1.2-UP#	2x1.2	72.5	30.0	45.0	325	390	≤ 35	2x17.5	2x3.0
STM-700-2x1.5-UP#	2x1.5	72.5	30.0	45.0	325	488	≤ 35	2x18.5	2x2.7
STM-700-2x2.0-UP#	2x2.0	72.5	30.0	45.0	325	650	≤ 35	2x19.7	2x2.3
STM-700-2x2.2-UP#	2x2.2	72.5	30.0	45.0	325	715	≤ 35	2x20.4	2x2.2
STM-700-2x2.5-UP#	2x2.5	84.0	30.0	45.0	325	813	≤ 35	2x22.5	2x2.0
STM-700-2x3.0-UP#	2x3.0	84.0	30.0	45.0	325	975	≤ 35	2x23.9	2x1.8
Un 1200VDC , Urms 500VAC , Us 1800V									
STM-1200-2x0.47-UP#	2x0.47	72.5	30.0	45.0	650	306	≤ 35	2x14.3	2x4.5
STM-1200-2x0.56-UP#	2x0.56	72.5	30.0	45.0	650	364	≤ 35	2x15.3	2x3.9
STM-1200-2x0.68-UP#	2x0.68	72.5	30.0	45.0	650	442	≤ 35	2x16.5	2x3.3
STM-1200-2x0.82-UP#	2x0.82	72.5	30.0	45.0	650	533	≤ 35	2x17.2	2x3.1
STM-1200-2x1.0-UP#	2x1.0	72.5	30.0	45.0	650	650	≤ 35	2x18.1	2x2.8
STM-1200-2x1.2-UP#	2x1.2	84.0	30.0	45.0	650	780	≤ 35	2x20.5	2x2.4
STM-1200-2x1.5-UP#	2x1.5	84.0	30.0	45.0	650	975	≤ 35	2x21.8	2x2.2
Un 1700VDC , Urms 575VAC , Us 2550V									
STM-1700-2x0.22-UP#	2x0.22	72.5	30.0	45.0	880	194	≤ 35	2x11.6	2x6.7
STM-1700-2x0.33-UP#	2x0.33	72.5	30.0	45.0	880	290	≤ 35	2x13.2	2x5.2
STM-1700-2x0.47-UP#	2x0.47	72.5	30.0	45.0	880	414	≤ 35	2x15.1	2x4.0
STM-1700-2x0.56-UP#	2x0.56	72.5	30.0	45.0	880	493	≤ 35	2x16.2	2x3.5
STM-1700-2x0.68-UP#	2x0.68	72.5	30.0	45.0	880	598	≤ 35	2x17.2	2x3.1
STM-1700-2x0.82-UP#	2x0.82	84.0	30.0	45.0	880	722	≤ 35	2x19.6	2x2.7
STM-1700-2x1.0-UP#	2x1.0	84.0	30.0	45.0	880	880	≤ 35	2x20.3	2x2.5